

katalog Ściernic

dla przemysłu drzewnego

GRINDING WHEELS FOR WOODWORKING INDUSTRY
SCHLEIFSCHEIBEN FÜR HOLZVERARBEITENDE INDUSTRIE
ШЛИФОВАЛЬНЫЕ КРУГИ ДЛЯ ДЕРЕВООБРАБАТЫВАЮЩЕЙ ПРОМЫШЛЕННОСТИ



DIAMENTPOOL

- 4-6** AKEMAT
- 7** DROZDOWSKI
- 8** GÖCKEL/REFORM
- 8** HEDER
- 9** KUCHARCZYK
- 10-11** LAKFAM
- 11** LOROCH, SCHMIDT-TEMPO
- 12** MAKITA
- 12-15** VOLLMER BIBERACH
- 16-21** VOLLMER DORNHAN
- 22-25** WALTER
- 25-26** WAPIENICA GLOBUS
- 26-28** WEINIG RONDAMAT
- 28-33** WIDMANN



KN AKEMAT

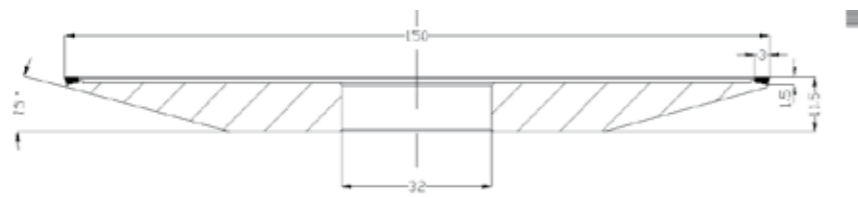

Akemat B		D	W	X	T
KN 150x 3x 1.5x 32 D76 C125T		150	3	1.5	11.5

ATAK AKEMAT

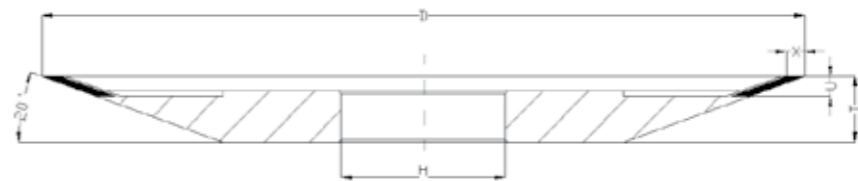

Akemat B		D	X	U	T
ATAK 150x 2.3x 4x 32 D76 C125T		150	2.3	4	13
ATAK 150x 3.5x 4x 32 D76 C125T		150	3.5	4	13
Akemat U6 R2					
ATAK 200x 2.3x 4x 32 D76 C125T		200	2.3	4	17
ATAK 200x 3.5x 4x 32 D76 C125T		200	3.5	4	17

VB8 AKEMAT

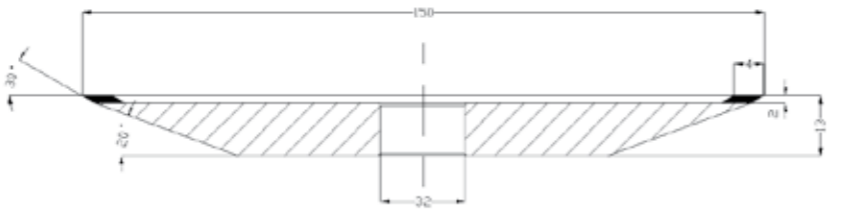

Akemat B		D	W	X	T
VB8 150x 4x 2x 32 D76 C125T		150	4	2	13
Akemat U6 R2					
VB8 200x 4x 2x 32 D76 C125T		200	4	2	15

VD9 AKEMAT

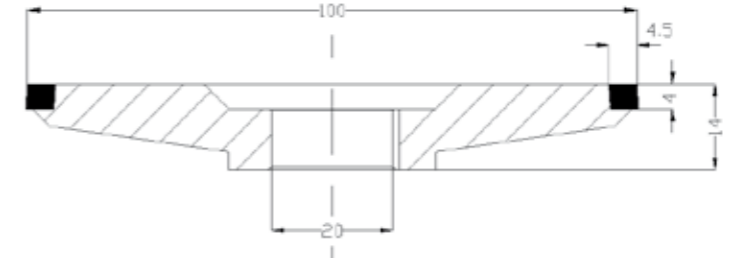

Akemat F		D	U	X	T
VD9 76x 4x 4.5x 20 D107 C75		76	4	4.5	14
VD9 100x 4x 4.5x 20 D107 C75		100	4	4.5	14

1A1D AKEMAT

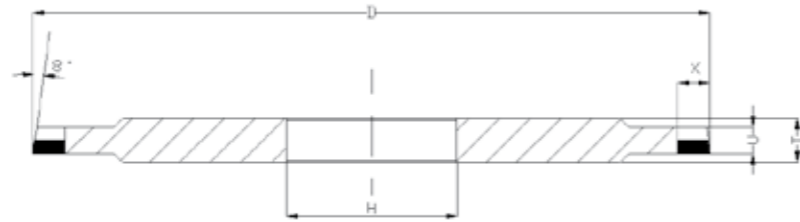

Akemat U, U6 R2		D	U (U1+U2)	X	T
1A1D 125x 5x 5x 32 D126/46 C100/75		125	5 (2.5+2.5)	5	8
1A1D 125x 5x 5x 32 D126/46 C100/75		125	5 (3.0+2.0)	5	8
1A1D 125x 5x 6x 32 D126/46 C100/75		125	5 (2.5+2.5)	6	8
1A1D 125x 5x 6x 32 D126/46 C100/75		125	5 (3.0+2.0)	6	8
1A1D 125x 5x 10x 32 D126/46 C100/75		125	5 (2.5+2.5)	10	8
1A1D 125x 5x 10x 32 D126/46 C100/75		125	5 (3.0+2.0)	10	8
1A1D 127x 5x 7x 32 D126/46 C100/75		127	5 (2.5+2.5)	7	8
1A1D 127x 5x 7x 32 D126/46 C100/76		127	5 (3.0+2.0)	7	8

1A1W AKEMAT



	D	T	X	Y	L
1A1W	6.0	5, 6	1.5, 1.6, 1.75, 2	wg zamówienia / on request	
1A1W	6.2	5, 6	1.5, 1.6, 1.75, 2	nach dem Auftrag	
1A1W	6.5	5, 6	1.5, 1.6, 1.75, 2	по заказу	

CKE DROZDOWSKI

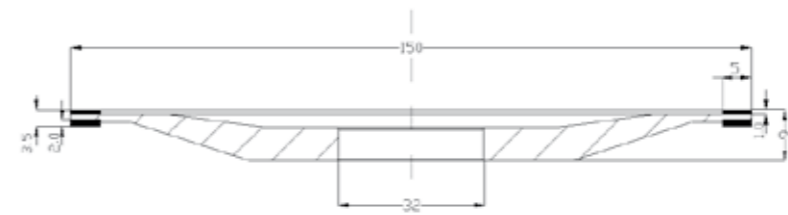

	D	W	X	T
CKE 150x 5x 1 (+5x 1.5)x 32 D126 C75M	150	5	1.0 (+1.5)	9

4A2 DROZDOWSKI

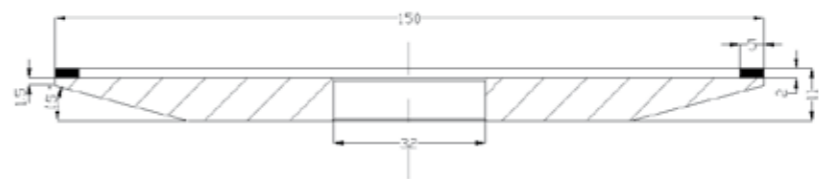

	D	W	X	T
4A2 150x 5x 2x 32 D126 C75M	150	5	2	11

6A2 GÖECKEL REFORM

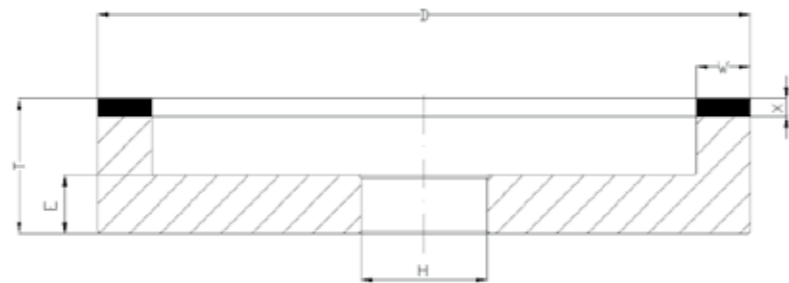

	D	W	X	T-X
6A2 200x 6x 4x 50/75	200	6	4	25, 27, 31
6A2 200x 8x 4x 50/75	200	8	4	25, 27, 31
6A2 200x 10x 4x 50/75	200	10	4	25, 27, 31
6A2 250x 6x 4x 50/75	250	6	4	25, 27, 31
6A2 250x 8x 4x 50/75	250	8	4	25, 27, 31
6A2 250x 10x 4x 50/75	250	10	4	25, 27, 31

CKE KUCHARCZYK

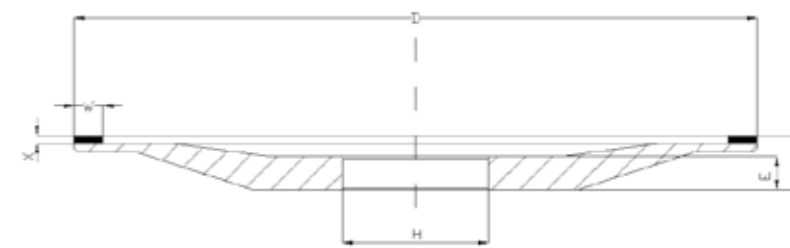

	D	W	X	T-X
CKE 150x 6x 1.5x 32 D46 C100M	150	6	1.5	12
CKE 150x 6x 1.5x 32 D76 C100M	150	6	1.5	12

4A2 HEDER

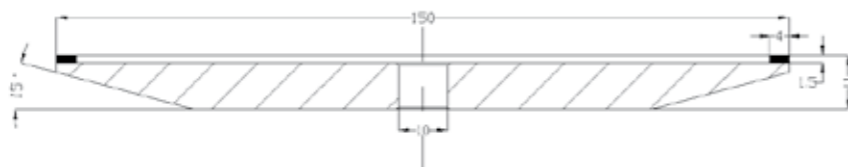

	D	W	X	T
4A2 150x 4x 1.5x 10 D107 C75	150	4	1.5	11

VB8 KUCHARCZYK

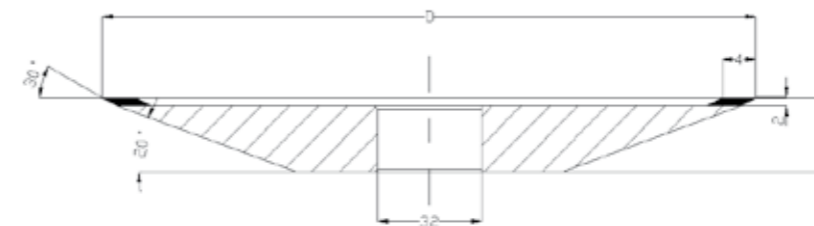

	D	W	X	T
VB8 125x 4x 2x 32 D46 C100T	125	4	2	13
VB8 125x 4x 2x 32 D76 C100T	125	4	2	13
VB8 150x 4x 2x 32 D46 C100T	150	4	2	13
VB8 150x 4x 2x 32 D76 C100T	150	4	2	13

**CKE
LAKFAM**

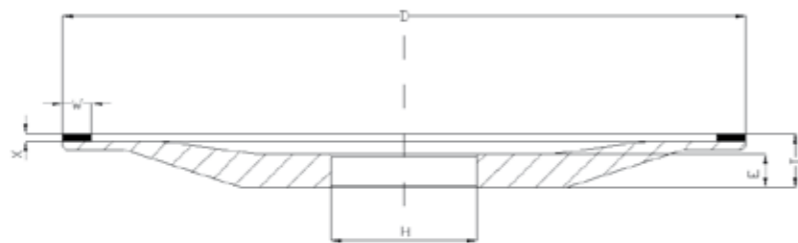

	D	W	X	T-X
CKE 125x 5x 1.5x H D107 C75	125	5	1.5	11

**VB8
LAKFAM**

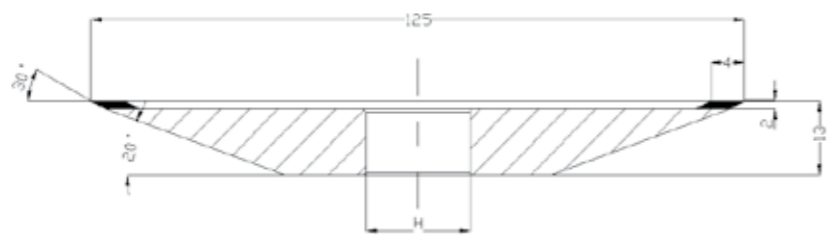

	D	W	X	T
VB8 125x 4x 2x H D107 C75	125	4	2	13

**VD14 dla Lakfam
LAKFAM**

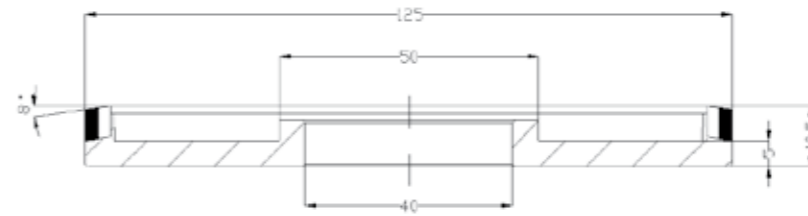

	D	W (W1+W2)	X	T
VD14 dla Lakfam 125x 5x 6x 40	125	5 (2.5+2.5)	6	10.5

**14F1 DLA LOROCH/ST
LOROCH,
SCHMIDT-TEMPO**

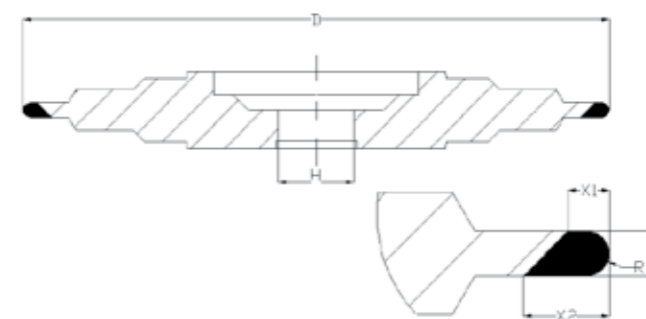

	D	U	X1	X2	R	H
14F1 dla Loroch/ST	150, 200	1.3	5	8	0.65	20, 32
	150, 200	1.6	5	8	0.80	20, 32
	150, 200	2.0	5	8	1.00	20, 32
	150, 200	2.5	5	8	1.25	20, 32
	150, 200	3.0	6	10	1.50	20, 32
	150, 200	3.2	6	10	1.60	20, 32
	150, 200	3.5	7	10	1.75	20, 32
	150, 200	4.0	7	10	2.00	20, 32

12A2 MAKITA

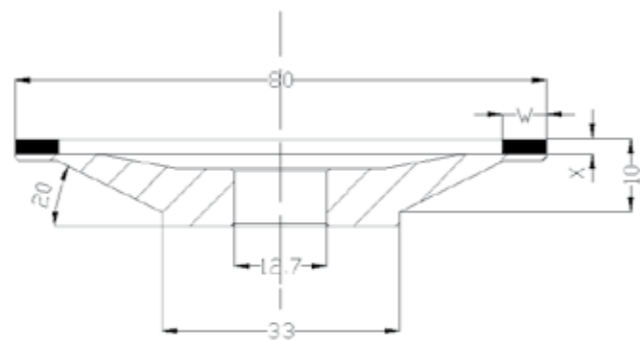

	D	W	X	T
12A2 80x 6x 1.5x 12.7 D76 C75M	80	6	1.5	10
12A2 80x 6x 1.5x 12.7 D107 C75M	80	6	1.5	10
12A2 80x 6x 2.0x 12.7 D76 C75M	80	6	2.0	10
12A2 80x 6x 2.0x 12.7x D107 C75M	80	6	2.0	10

VB8 VOLLMER BIBERACH

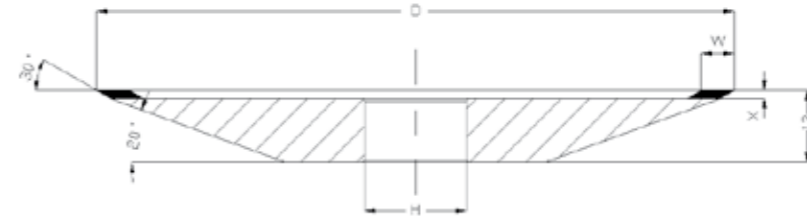

	D	W	X	T-X
UNIMAT S				
VB8 100x 4x 2x 25 D76 C125T	100	4	2	11
CHC, CHCB, CHP, CE, CEP, CEN, CHM, CB, CC, CHT, CHHT, CNHB, CHTS, CX				
VB8 125x 4x 2x 32 D76 C125T	125	4	2	11
CHD, SERVICE CENTER				
VB8 200x 4x 2x 32 D76 C125T	200	4	2	13

CKE VOLLMER BIBERACH

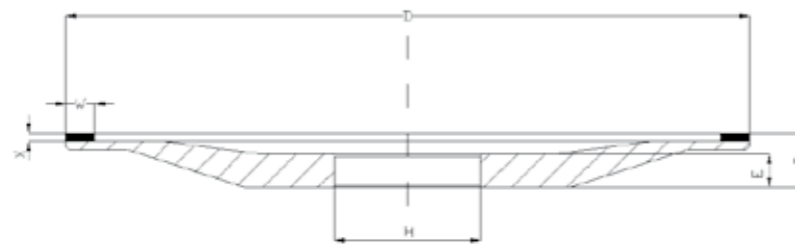

	D	W	X	T-X
CHC, CHCB, CHP, CE, CEP, CEN, CHM, CB, CC, CHT, CHHT, CNHB, CHTS				
CKE 125x 4x 1.5x 32 D76 C100	125	4	1, 1.5	11
CKE 125x 5x 1.5x 32 D76 C100	125	5	1, 1.5	11
CKE 125x 6x 1.5x 32 D76 C100	125	6	1, 1.5	11

ATAK VOLLMER BIBERACH

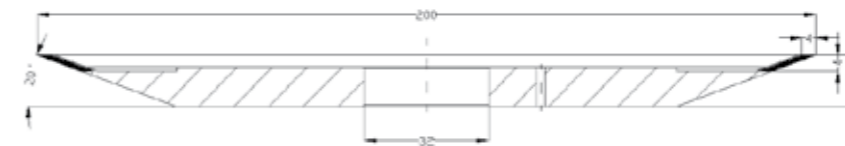

	D	X	U	T
CHC, CHCB, CHP, CE, CEP, CEN, CHM, CB, CC, CHT, CHHT, CNHB, CHTS, CX				
ATAK 125x 2.3x 4x 32 D76 C125T	125	2.3	4	13
ATAK 125x 3.5x 4x 32 D76 C125T	125	3.5	4	13
CHD, SERVICE CENTER				
ATAK 200x 2.3x 4x 32 D76 C125T	200	2.3	4	17
ATAK 200x 3.5x 4x 32 D76 C125T	200	3.5	4	17

VD14
VOLLMER BIBERACH

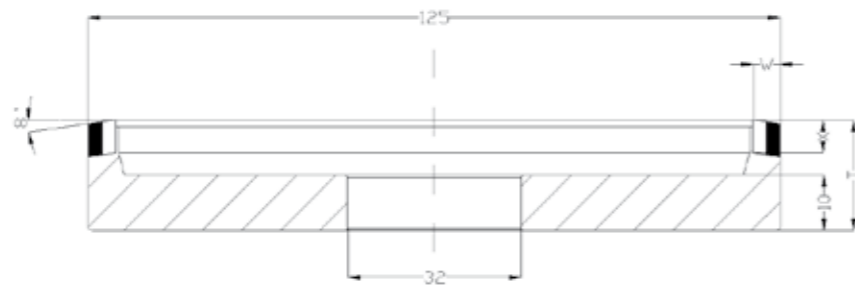

		D	W (W1+W2)	X	T
CHC, CHP, CEP, CEN, CHM, CB, CC, CHHT, CHD, CX, SERVICE CENTER	VD14 125x 5x 6x 32 D126/46 C100/75T	125	5 (2.5+2.5)	6	18
	VD14 125x 5x 10x 32 D126/46 C100/75T	125	5 (2.5+2.5)	10	22
	VD14 125x 5.5x 6x 32 D126/46 C100/75T	125	5.5 (3.5+2.0)	6	18
	VD14 125x 5.5x 10x 32 D126/46 C100/75T	125	5.5 (3.5+2.0)	10	22

VB5
VOLLMER BIBERACH

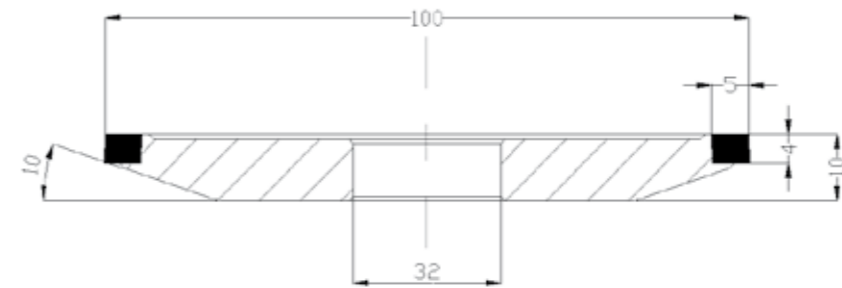

		D	U	X	T
CC, CEF, CFL, CHAFT, CHFTE, CH HF, CHTF, CHF, FS	VB5 100x 4x 5x 32 D107 C75	100	4	5	10

VB4
VOLLMER BIBERACH

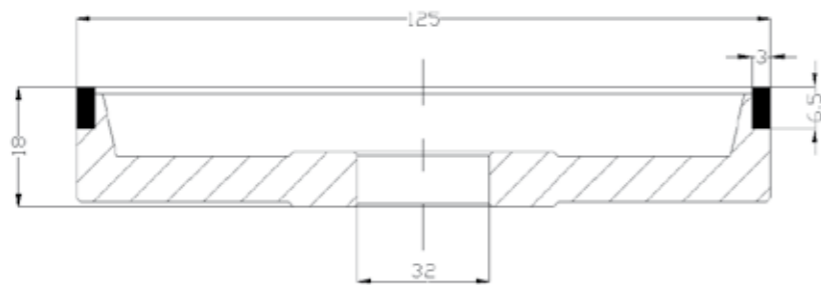

		D	W	X	T
CC, CB, CE, CHC, CHO, CEP, CEN, CHM, CHT, CHTS, CHHT, CX	VB4 125x 3x 6.5x 32 D54 C100T	125	3	6.5	18

1A1W
VOLLMER BIBERACH



	D	T	X	Y	L
1A1W	6.0	5, 6	1.5, 1.6, 1.75, 2	wg zamówienia / on request	
1A1W	6.2	5, 6	1.5, 1.6, 1.75, 2	nach dem Auftrag	
1A1W	6.5	5, 6	1.5, 1.6, 1.75, 2	по заказу	

4A2
VOLLMER DORNHAN

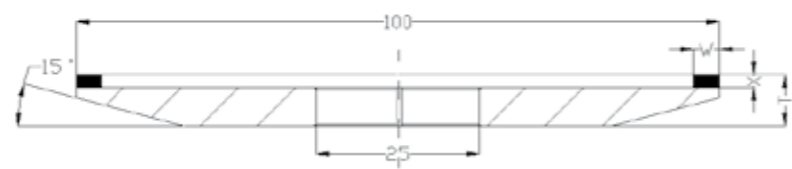

	D	W	X	T-X
4A2 100x 3x 2x 25	100	3	1, 2, 3, 4	6
4A2 100x 4x 3x 25	100	4	1, 2, 3, 4	6
4A2 100x 5x 1x 25	100	5	1, 2, 3, 4	6

CKE
VOLLMER DORNHAN

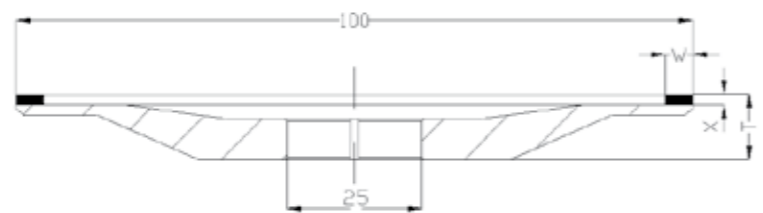

	D	W	X	T-X
CKE 100x 4x 1.5x 25	100	4	1, 1.5	8
CKE 100x 5x 1.5x 25	100	5	1, 1.5	8
CKE 100x 6x 1.5x 25	100	6	1, 1.5	8

VB8
VOLLMER DORNHAN



	D	W	X	T-X
VB8 100x 4x 2x 25	100	4	2	8
VB8 125x 4x 2x 25	125	4	2	11

**VB8 DLA ALFA,
BETA, GAMMA**
VOLLMER DORNHAN



	D	W	X	T-X
VB8 dla Alfa, Beta, Gamma 175x 4x 2x 50.8	175	4	2	10

ATAK
VOLLMER DORNHAN



	D	X	U	T
ATAK 125x 2.3x 4x 25	125	2.3	4	13
ATAK 125x 3.5x 4x 25	125	3.5	4	13

VD3
VOLLMER DORNHAN

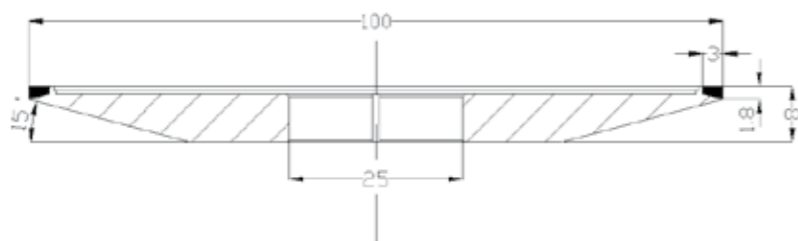

	D	W	X	T
VD3 100x 3x 1.8x 25	100	3	1.8	8

VD5
VOLLMER DORNHAN

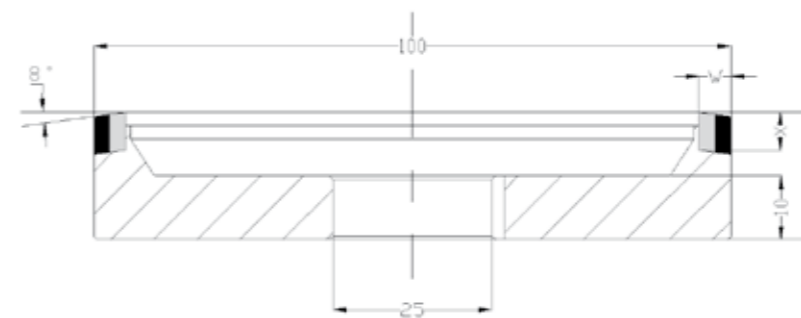

	D	W (W1+W2)	X	T
VD5 100x 5x 6x 25	100	5 (2.5+2.5)	6	20

VD8
VOLLMER DORNHAN

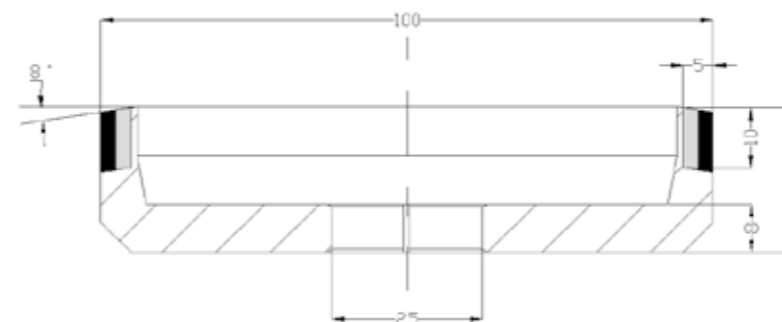

	D	W (W1+W2)	X	T
VD8 100x 5x 10x 25	100	5 (2.5+2.5)	10	24

VD9
VOLLMER DORNHAN

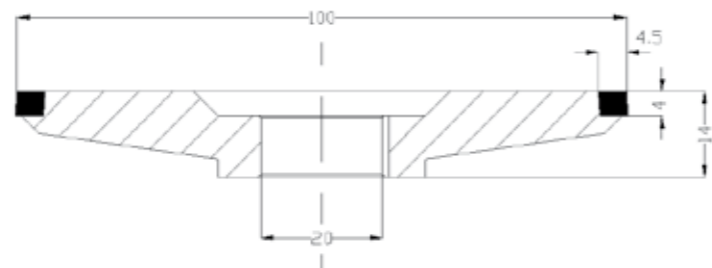

	D	U	X	T
VD9 76x 4x 4.5x 20	76	4	4.5	14
VD9 100x 4x 4.5x 20	100	4	4.5	14

VD11
VOLLMER DORNHAN

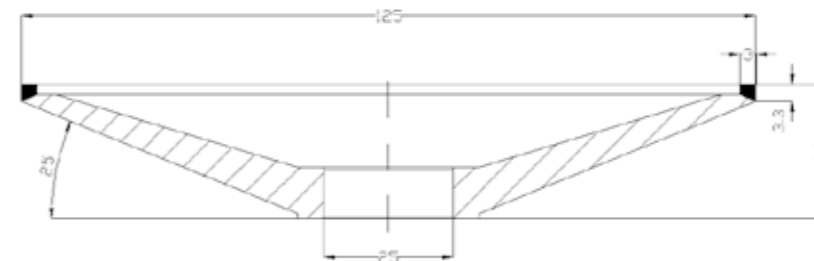

	D	W	X	T
VD11 125x 3x 3.3x 25	125	3	3.3	26

VD10
VOLLMER DORNHAN

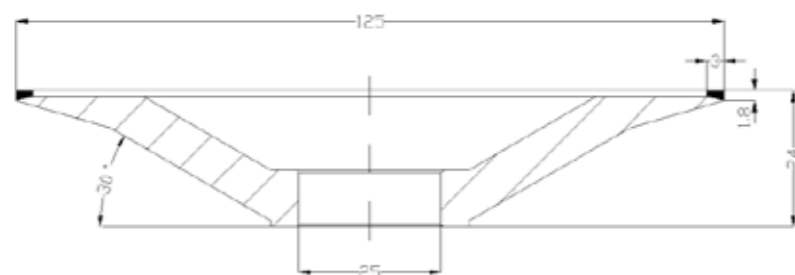

	D	W	X	T
VD10 125x 3x 1.8x 25	125	3	1.8	24

VD12
VOLLMER DORNHAN

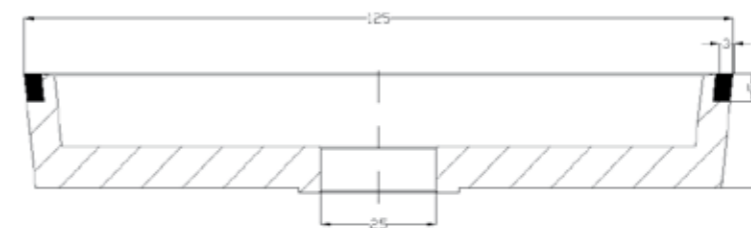

	D	W	X	T
VD12 125x 3x 5x 25	125	3	5	26

ATAK WALTER

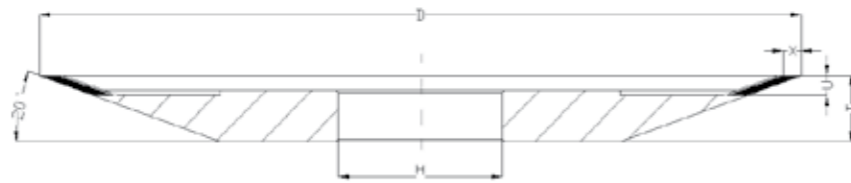

		D	X	U	T-X
NC2, NC3, NC4	ATAK 150x 2.3x 4x 32 D46 C125T	150	2.3	4	13
	ATAK 150x 3.5x 4x 32 D46 C125T	150	3.5	4	13
NC3, C5	ATAK 160x 2.3x 4x 32 D46 C125T	160	2.3	4	13
	ATAK 160x 3.5x 4x 32 D46 C125T	160	3.5	4	13
CNC5	ATAK 200x 2.3x 4x 32 D46 C125T	200	2.3	4	17
	ATAK 200x 3.5x 4x 32 D46 C125T	200	3.5	4	17

1A1W WALTER



	D	T	X	Y	L
1A1W	6.0	5, 6	1.5, 1.6, 1.75, 2	wg zamówienia / on request	
1A1W	6.2	5, 6	1.5, 1.6, 1.75, 2	nach dem Auftrag	
1A1W	6.5	5, 6	1.5, 1.6, 1.75, 2	по заказу	

VD9 WALTER

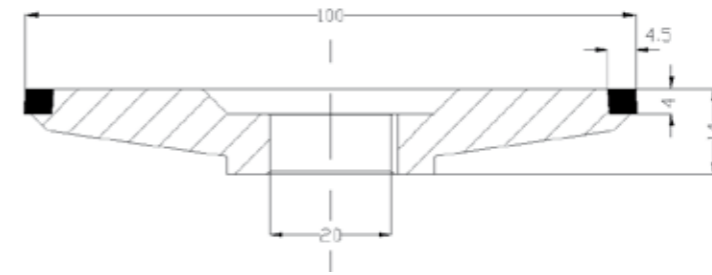

	D	U	X	T
VD9 76x 4x 4.5x 32 D64 C100	76	4	4.5	14
VD9 100x 4x 4.5x 32 D64 C100	100	4	4.5	14

1A1D WALTER

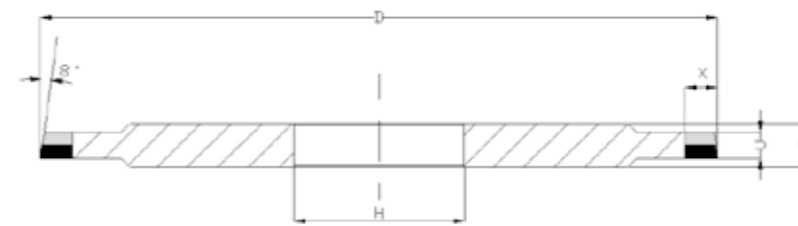

		D	U (U1+U2)	X	T
NC3, NC4, CNC5, C5	1A1D 150x 5x 8x 32 D107/46 C100/75	150	5 (2.5+2.5)	6, 8	8
	1A1D 150x 5x 8x 32 D126/46 C100/75	150	5 (2.5+2.5)	6, 8	8
CNC5	1A1D 200x 5x 8x 32 D107/46 C100/75	200	5 (2.5+2.5)	6, 8	8
	1A1D 200x 5x 8x 32 D126/46 C100/75	200	5 (2.5+2.5)	6, 8	8

KN WALTER

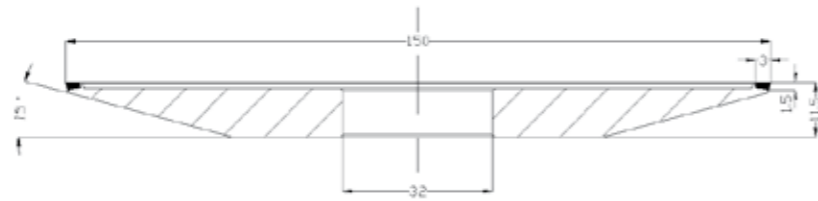

		D	W	X	T
NC2, NC3, NC4	KN 150x 3x 1.5x 32 D46 C125T	150	3	1.5	11.5

14A1 WALTER

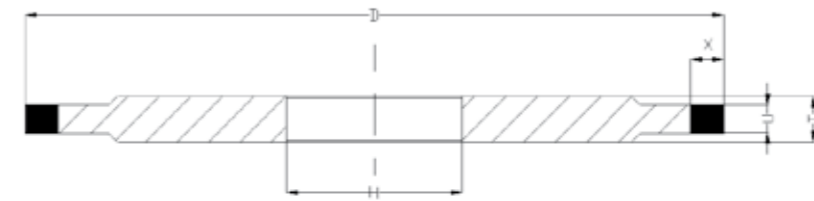

		D	U	X	T
NC3, NC4, CNC5, C5	14A1 150x 5x 6x 32 D64 C100	150	5	6	8
	14A1 150x 5x 8x 32 D64 C100	150	5	8	8

VB8 WALTER

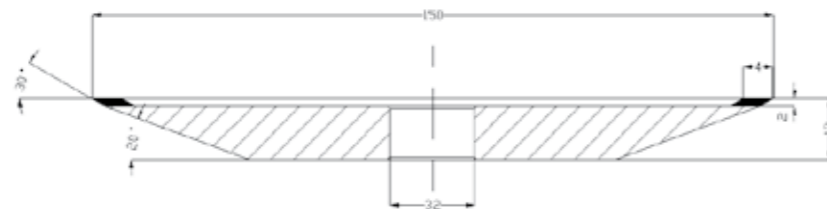

		D	W	X	T-X
NC2, NC3, NC4	VB8 150x 4x 2x 32 D46 C100T	150	4	2	11
	VB8 150x 4x 2x 32 D46 C125T	150	4	2	11
NC3, C5	VB8 160x 4x 2x 32 D46 C100T	160	4	2	11
	VB8 160x 4x 2x 32 D46 C125T	160	4	2	11
CNC5	VB8 200x 4x 2x 32 D46 C100T	200	4	2	13
	VB8 200x 4x 2x 32 D46 C125T	200	4	2	13

4A2 WAPIENICA

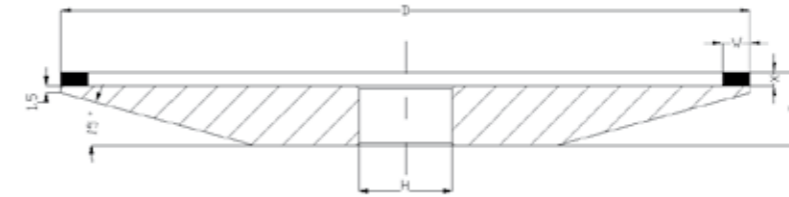

		D	W	X	T
4A2 150x 6x 2x 32 D107 C75M		150	6	2	11

CKE WAPIENICA

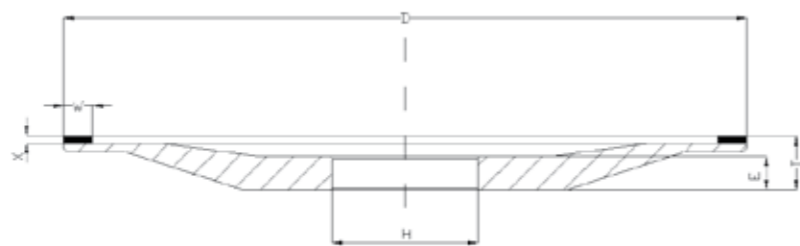

	D	W	X	T-X
CKE 150x 5x 1.5x 32 D107 C75M	150	5	1.5	12

14A1 WEINIG

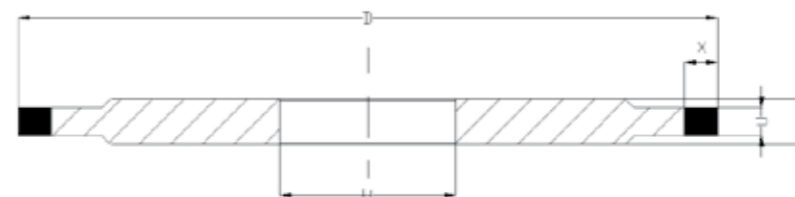

	D	U	X	T
14A1 200x 2x 5x 60	200	2	5	5, 10
14A1 200x 3x 6x 60	200	3	6	5, 10
14A1 200x 4x 5x 60	200	4	5	5, 10
14A1 200x 5x 5x 60	200	5	5	5, 10
14A1 200x 5x 6x 60	200	5	6	5, 10

14F1 WEINIG

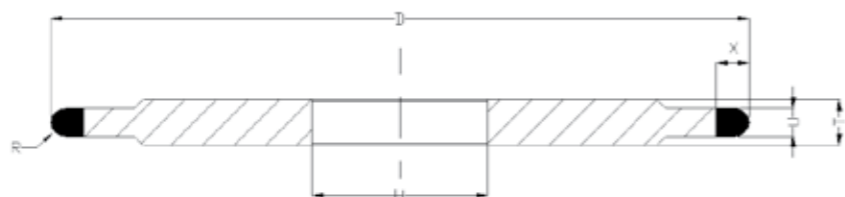

	D	U	X	R
14F1 200x 2x 5x 60	200	2	5	1.0
14F1 200x 3x 6x 60	200	3	6	1.5
14F1 200x 4x 5x 60	200	4	5	2.0
14F1 200x 5x 5x 60	200	5	5	2.5
14F1 200x 5x 6x 60	200	5	6	2.5

W12 WEINIG

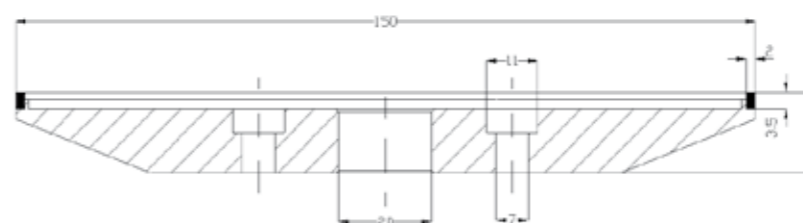

	D	W	X	T
W12 150x 2x 3.5x 20	150	2	3.5	17

**WI13
WEINIG**

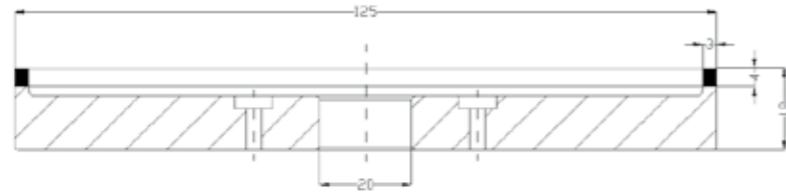

	D	W	X	T
WI13 125x 3x 4x 20	125	3	4	18

**WI3
WIDMANN**

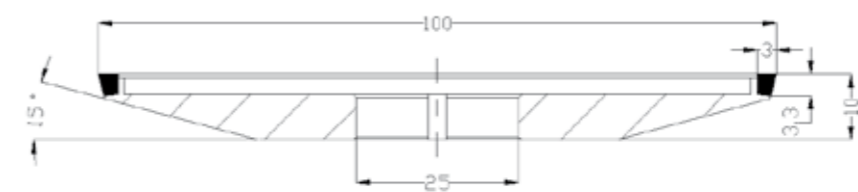

	D	W	X	T
WI3 100x3x3.3x25	100	3	3.3	10

**WI1
WIDMANN**

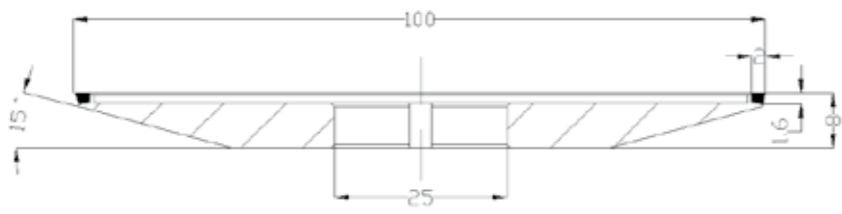

	D	W	X	T
WI1 100x2x1.6x25	100	2	1.6	8

**VB8
WIDMANN**

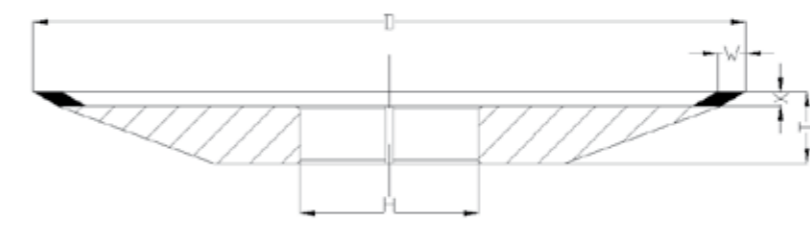

	D	W	X	T-X
VB8 100x4x2x25	100	4	2	8

**WI6
WIDMANN**

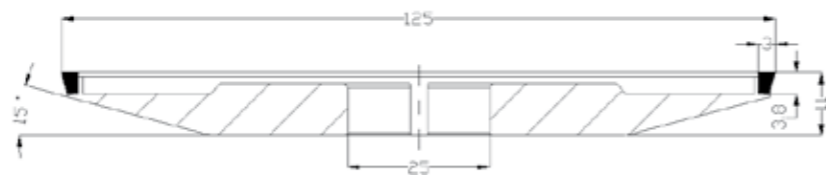

	D	W	X	T
WI6 125x3x3.8x25	125	3	3.8	11

**WI7
WIDMANN**

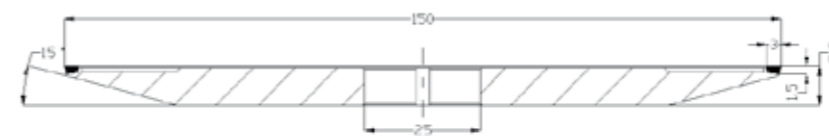

	D	W	X	T
WI7 150x3x1.5x25	150	3	1.5	8.3

**VB8
WIDMANN**

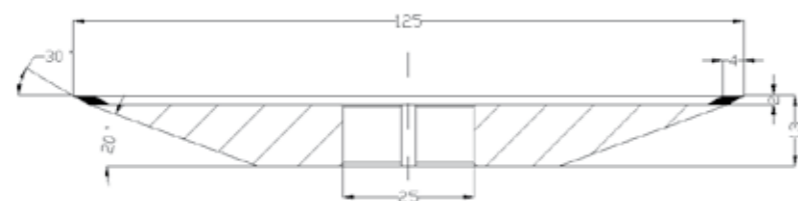

	D	W	X	T-X
VB8 125x4x2x25	125	4	2	11

**VB8
WIDMANN**

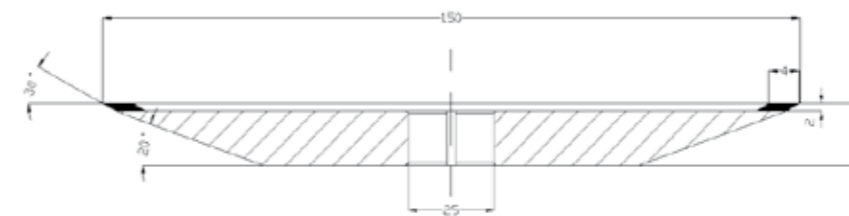

	D	W	X	T-X
VB8 150x4x2x25	150	4	2	11

WI10 WIDMANN

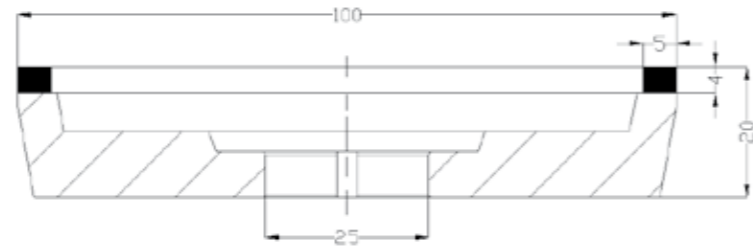

	D	W	X	T
WI10 100x5x4x25	100	5	4	20

VD14 WIDMANN

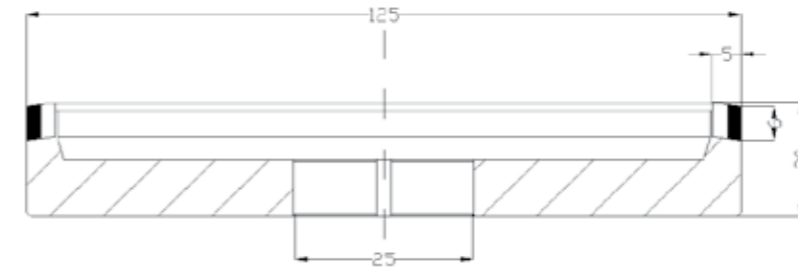

	D	W (W1+W2)	X	T
VD14 125x5x6x25	125	5 (2.5+2.5)	6	20

VD5 WIDMANN

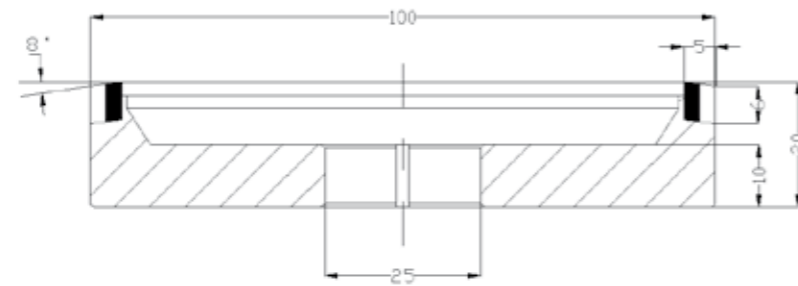

	D	W (W1+W2)	X	T
VD5 100x5x6x25	100	5 (2.5+2.5)	6	20

VD9 WIDMANN

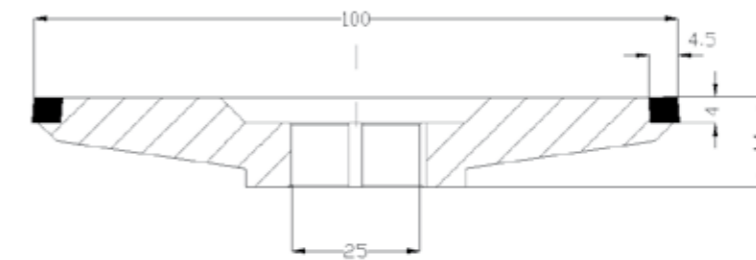

	D	U	X	T
VD9 100x4x4.5x25	100	4	4.5	14

DIAMENTPOOL



DIAMENTPOL
40-956 Katowice,
ul. Graniczna 29, Poland

www.diamentpol.com.pl
poczta@diamentpol.com.pl

www.diamentpol.eu
info@diamentpol.eu

tel. +48 32 256 5969, 256 1243
fax +48 32 256 1470, 256 0911